

SPIE
Optifab

DTI Dyna Technologies, Inc.

GP-10000HT Series Precision Glass Molding Machine

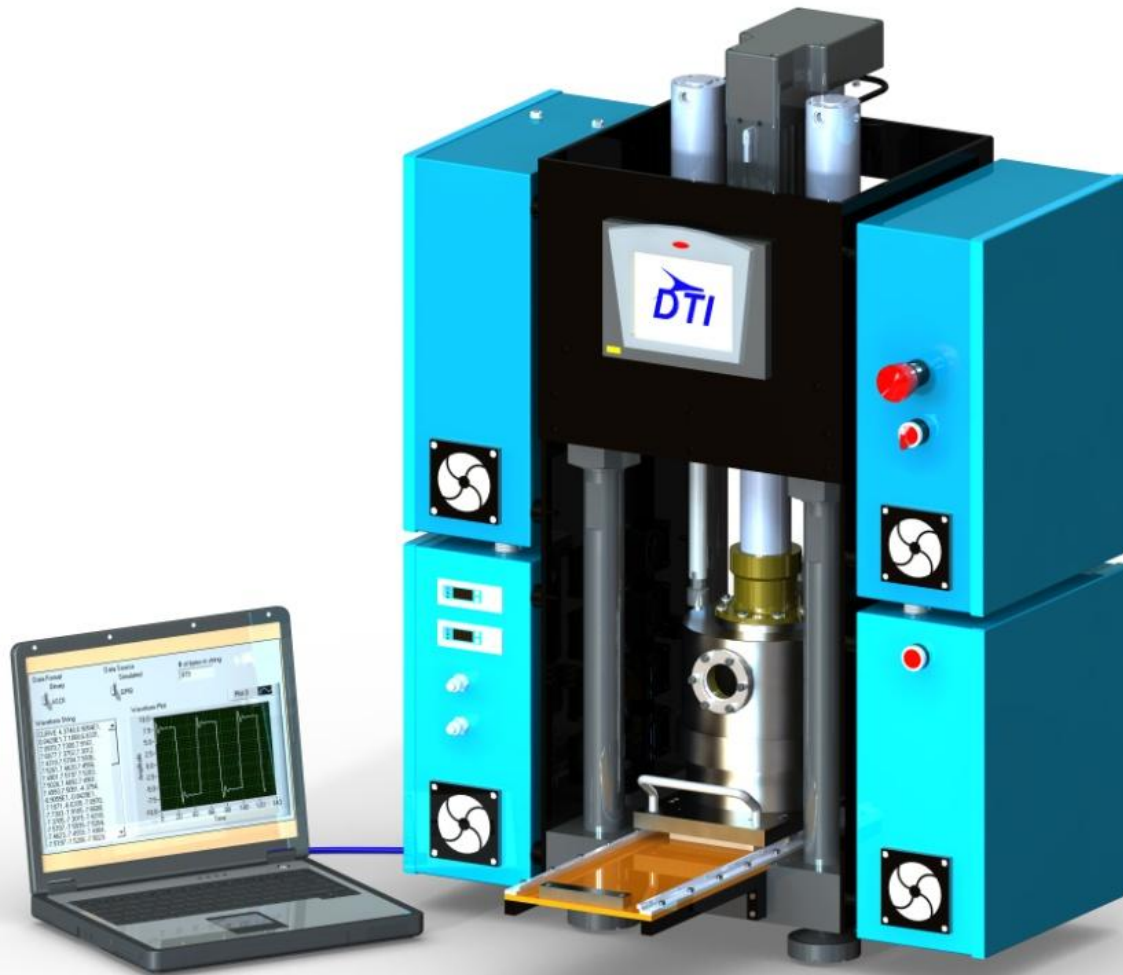

Precision Glass Molding Press Functions

- Auto-molding capability
- Controlled environment
- Upper and lower mold temperature feedback
- Precision electric actuation
- Upper and lower force measurement
- Temperature ramp
- Real-time data acquisition

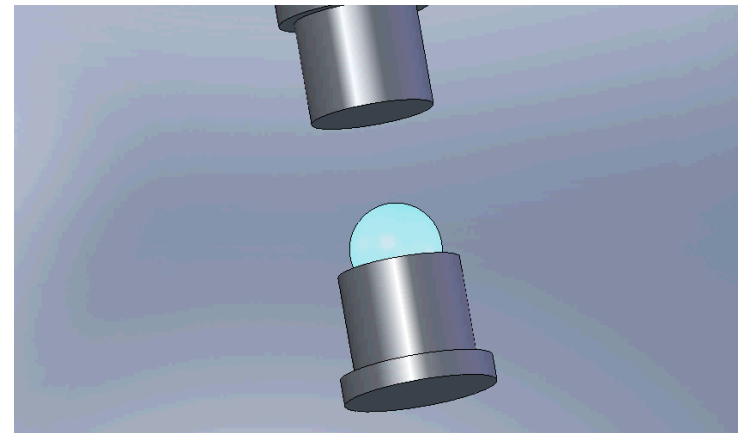

Temperature Ramp Capability

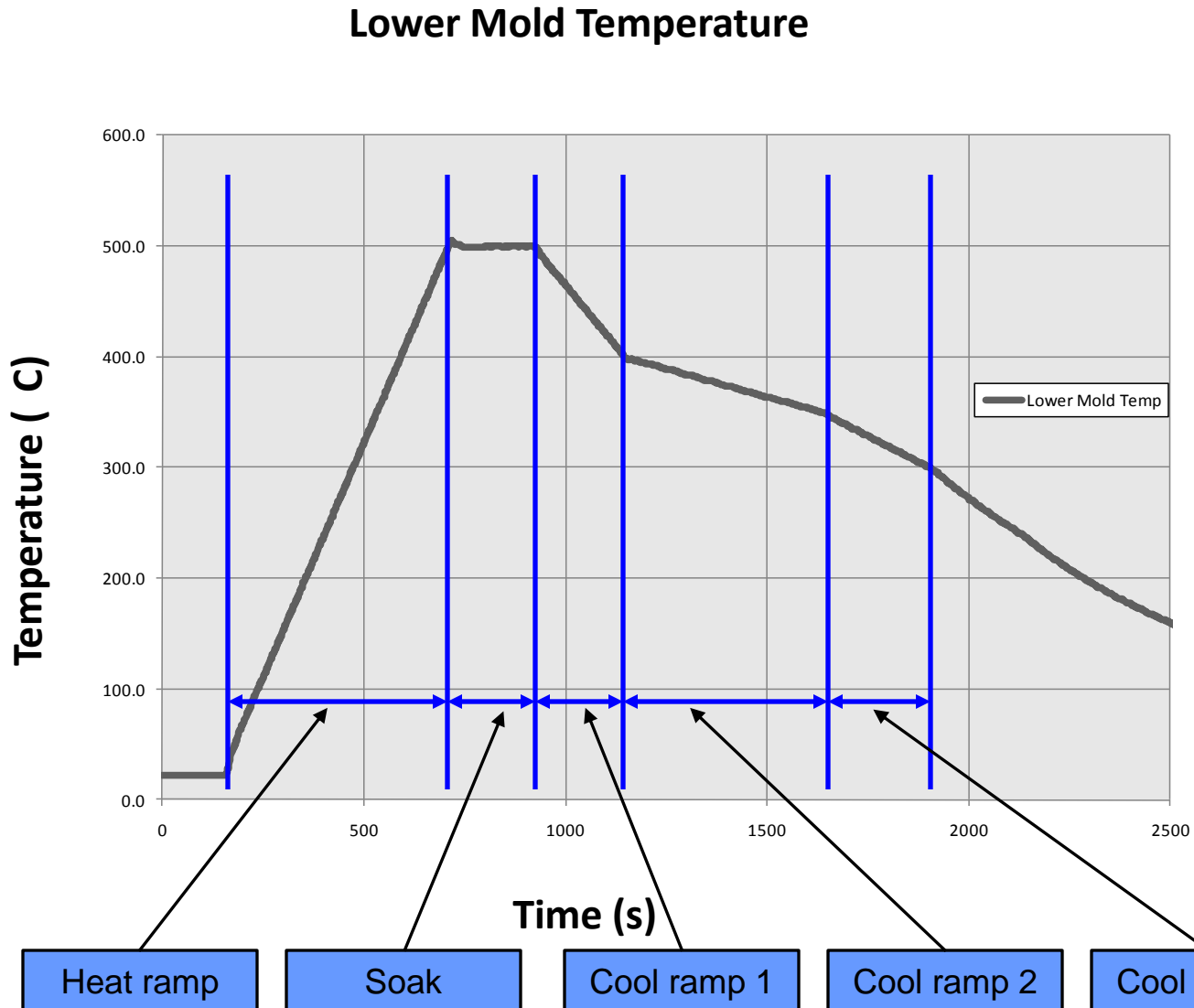

GP-10000HT cross-section

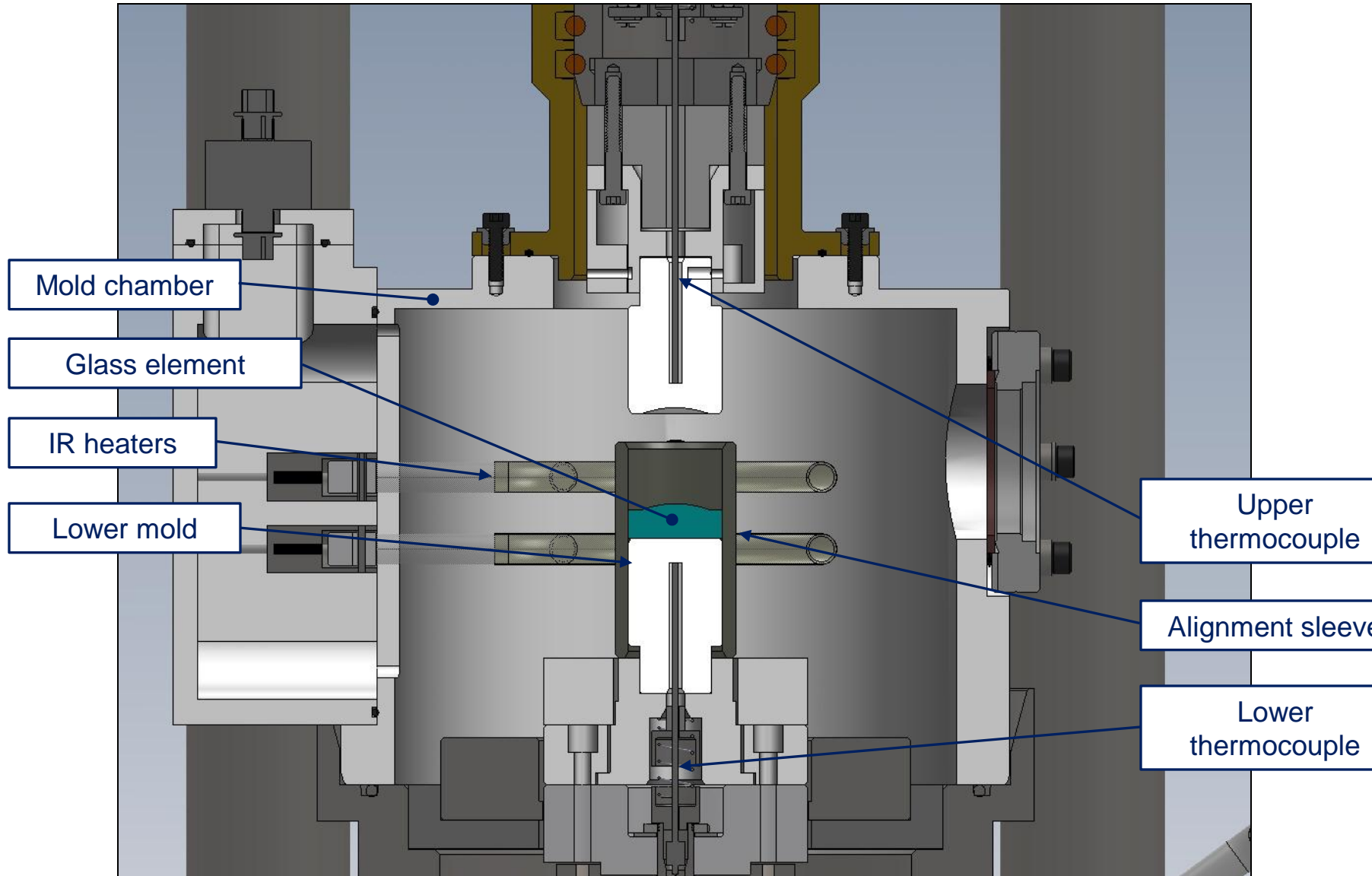

Purge Cycle

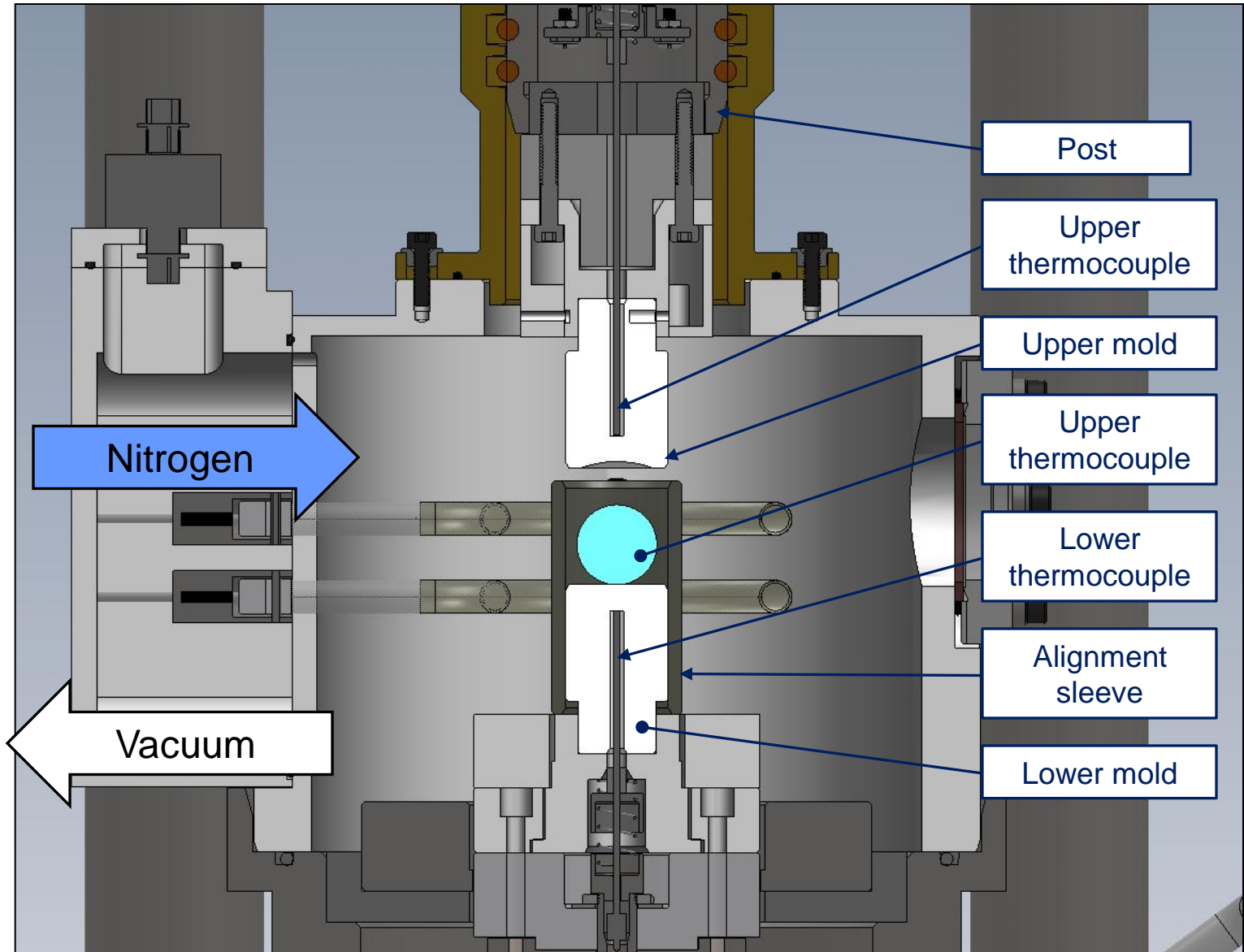

Heating Cycle

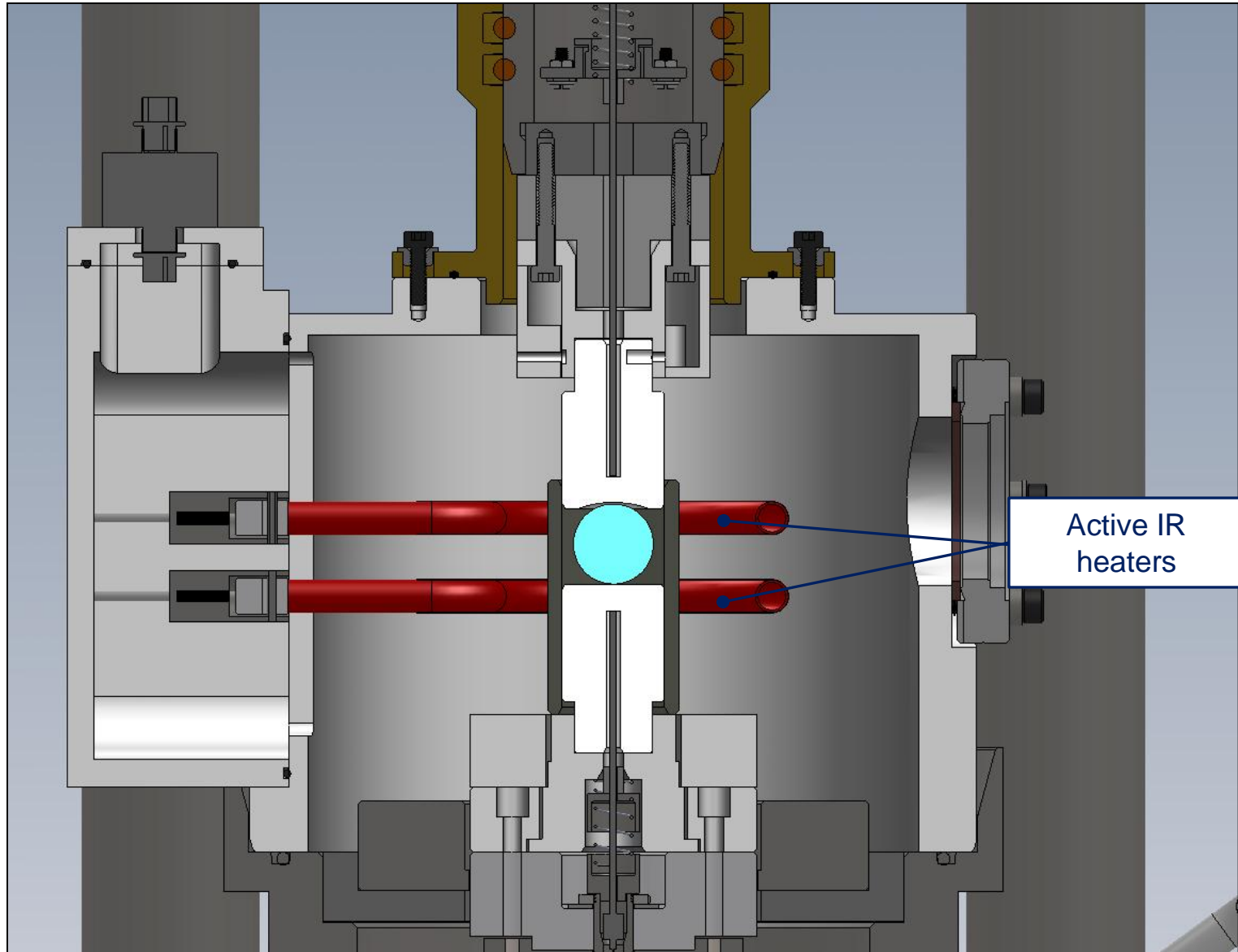

Heating Cycle

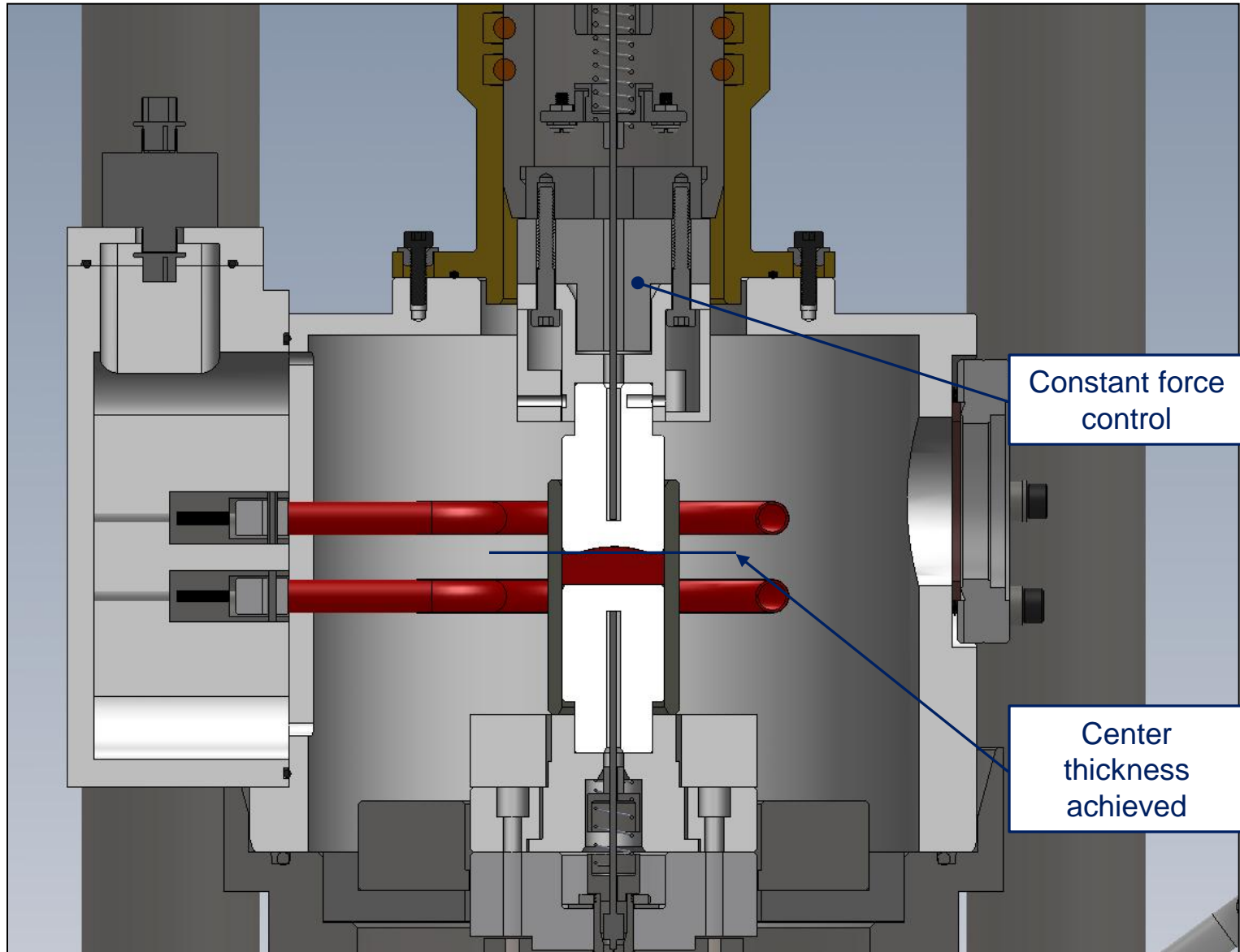

Cooling Cycle

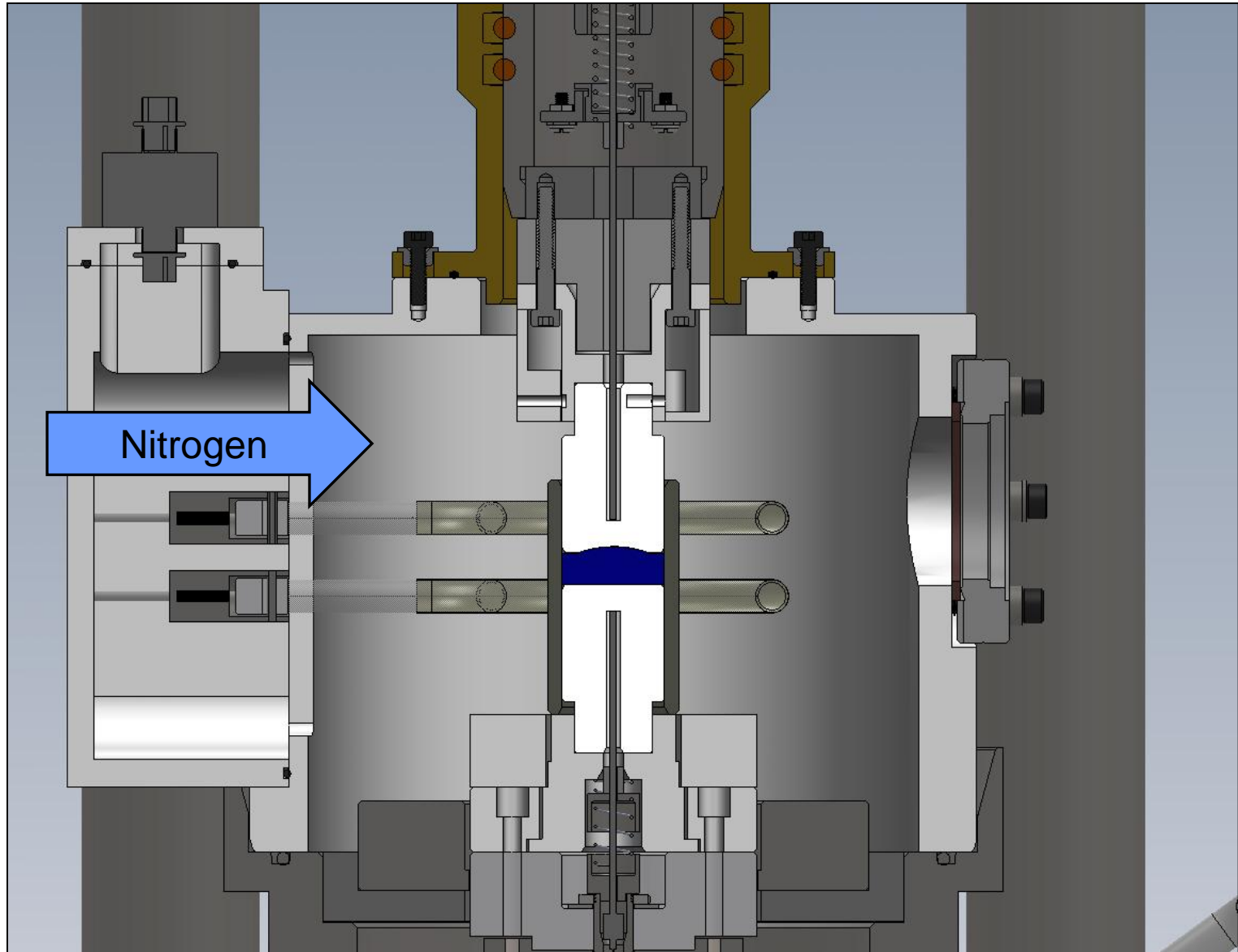

GP-10000 HT (High Temperature)

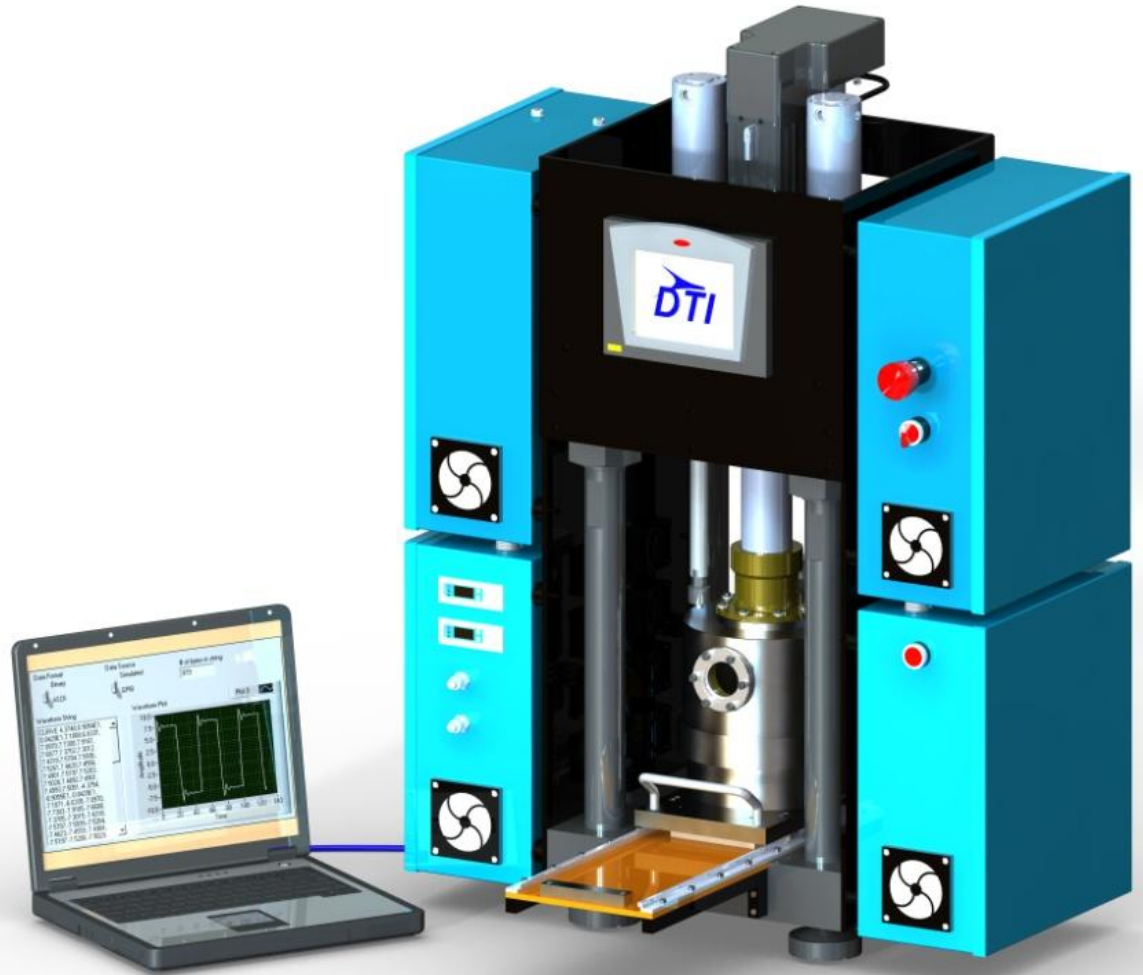

GP-10000 HT (High Temperature)

Features:

- Mold temperatures to 800 C
- Improved control of position and force
- Movements based on user defined position, velocity and force
- Optical encoder for position control
- Touch screen PLC
- Compatible with LabView
- CE rating pending

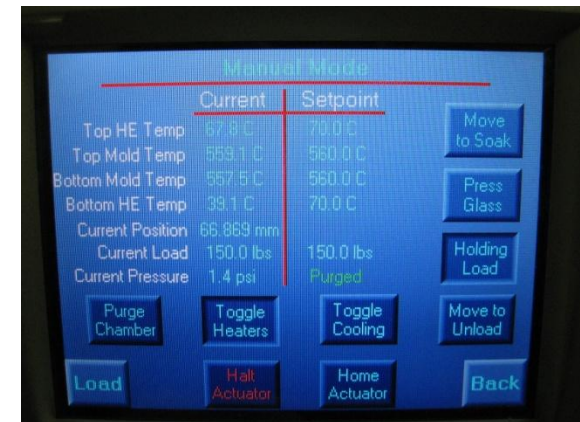

Picture of PLC screen

Typical Aspheric Lens

Center Thickness (CT)	+/- 0.025
Index n_d	+/- 0.002
Abbe Number v_d	+/- 2%
Diameter (mm)	+/- 0.015
Decentration (mm)	+/- 0.010
Wedge (arcmin)	+/- 3
Power/Irregularity (fringes)	1/0.5
Total RMS Shape Error (nm)	100
Surface Roughness (nm)	15
Surface Quality (scratch-dig)	40-20